

# PRODUCT INFORMATION PACKET

Model No: 056T17T5305  
Catalog No: G580  
1/3,1725,TENV,56C,3/60/208-230/460  
Totally Enclosed Non-Ventilated (TENV)



Regal and Marathon are trademarks of Regal Beloit Corporation or one of its affiliated companies.  
©2018 Regal Beloit Corporation, All Rights Reserved. MC017097E



### Nameplate Specifications

Output HP	<b>0.33 Hp</b>	Output KW	<b>0.25 kW</b>
Frequency	<b>60 Hz</b>	Voltage	<b>208-230/460 V</b>
Current	<b>1.8-1.6/0.80 A</b>	Speed	<b>1725 rpm</b>
Service Factor	<b>1.15</b>	Phase	<b>3</b>
Efficiency	<b>68 %</b>	Duty	<b>Continuous</b>
Insulation Class	<b>F</b>	Design Code	<b>B</b>
KVA Code	<b>N</b>	Frame	<b>56C</b>
Enclosure	<b>Totally Enclosed Non Ventilated</b>	Overload Protector	<b>No</b>
Ambient Temperature	<b>40 °C</b>	Drive End Bearing Size	<b>6203</b>
Opp Drive End Bearing Size	<b>6203</b>	UL	<b>Recognized</b>
CSA	<b>Y</b>	CE	<b>Y</b>
IP Code	<b>43</b>		

### Technical Specifications

Electrical Type	<b>Squirrel Cage Induction Run</b>	Starting Method	<b>Across The Line</b>
Poles	<b>4</b>	Rotation	<b>Reversible</b>
Mounting	<b>Bolt-on Base</b>	Motor Orientation	<b>Horizontal Or Up Or Down</b>
Drive End Bearing	<b>Ball</b>	Opp Drive End Bearing	<b>Ball</b>
Frame Material	<b>Rolled Steel</b>	Shaft Type	<b>NEMA 56</b>
Overall Length	<b>9.93 in</b>	Frame Length	<b>6.06 in</b>
Shaft Diameter	<b>0.625 in</b>	Shaft Extension	<b>2.06 in</b>
Assembly/Box Mounting	<b>F1 Only</b>		
Outline Drawing	<b>A-100142-606</b>	Connection Diagram	<b>A-EE7308</b>

This is an uncontrolled document once printed or downloaded and is subject to change without notice. Date Created: 06/29/2018

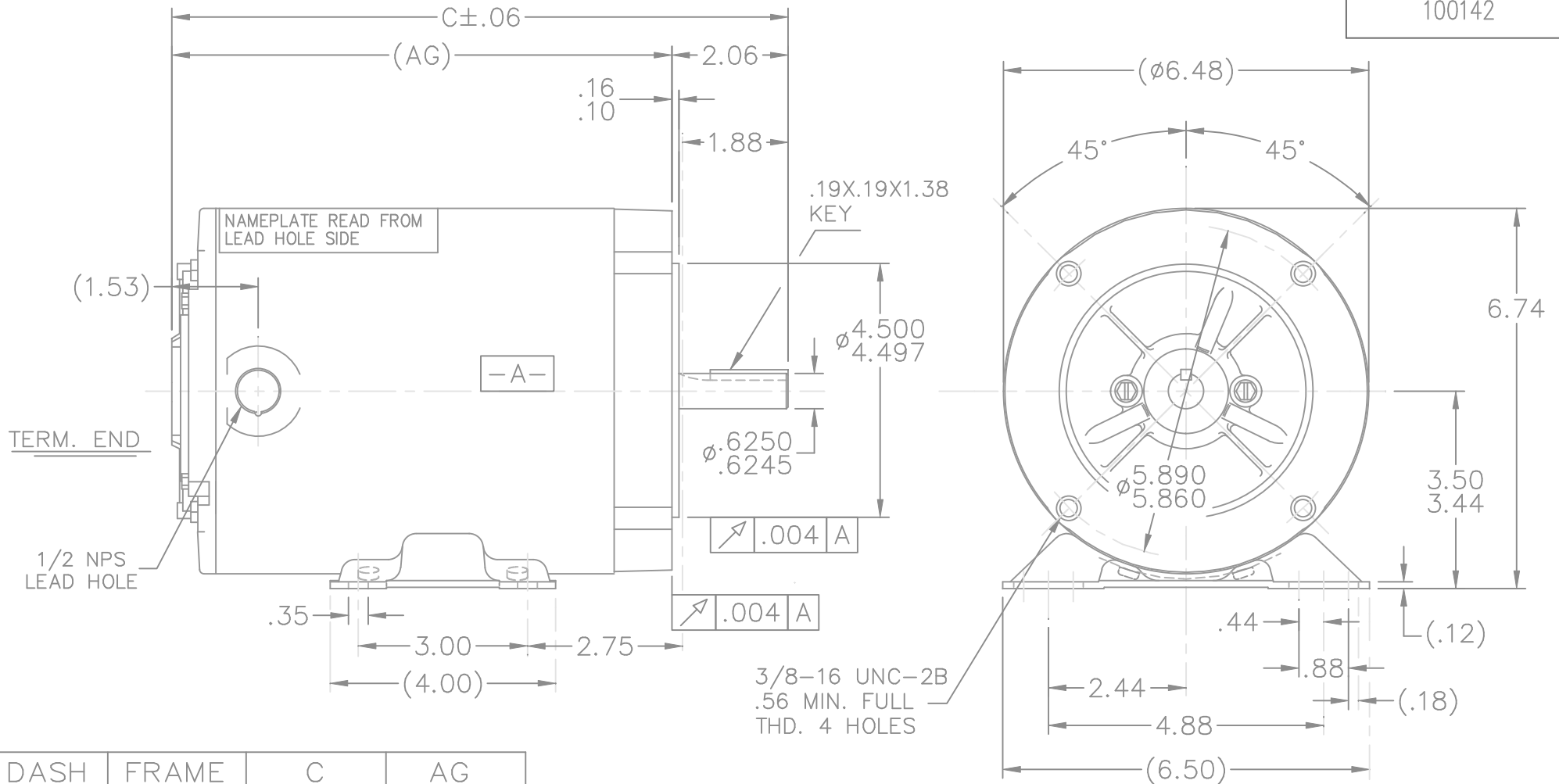

DASH	FRAME	C	AG
606	56-60	9.93	7.87
656	56-65	10.43	8.37

				TOLERANCES UNLESS SPECIFIED			DRAWN KL 04-15-1994			
				DEC.	INCHES		CHK ML 04-16-1994			
				.X	±.1		APPD GK 04-16-1994			
5	REDRAWN IN AUTOCAD	TAT 06-29-2004	ML	.XX	±.03	TITLE OUTLINE 56 FR.-BB-3 PHASE-'C' FACE (DIST.)	SCALE 3=8			
4	UPDATED TO NEW REAR BRACKET	BLR		.XXX	±.005		REF			
3	REDRAWN ON CADD - NO CHANGE	KL 04-16-1994		.XXXX	±.0005	MAT'L. FINISH	FMF			
NO.	REVISION	BY & DATE	CHK	ANG	±7'30"		PREV			
THIS DRAWING IN DESIGN AND DETAIL IS OUR PROPERTY AND MUST NOT BE USED EXCEPT IN CONNECTION WITH OUR WORK ALL RIGHTS OF DESIGN AND INVENTION ARE RESERVED THIS IS AN ELECTRONICALLY GENERATED DOCUMENT - DO NOT SCALE THIS PRINT				RFP		CAD FILE 100142	SIZE A	DRAWING NO. 100142	PAGE OF	REV. 5
				DIST	WP					

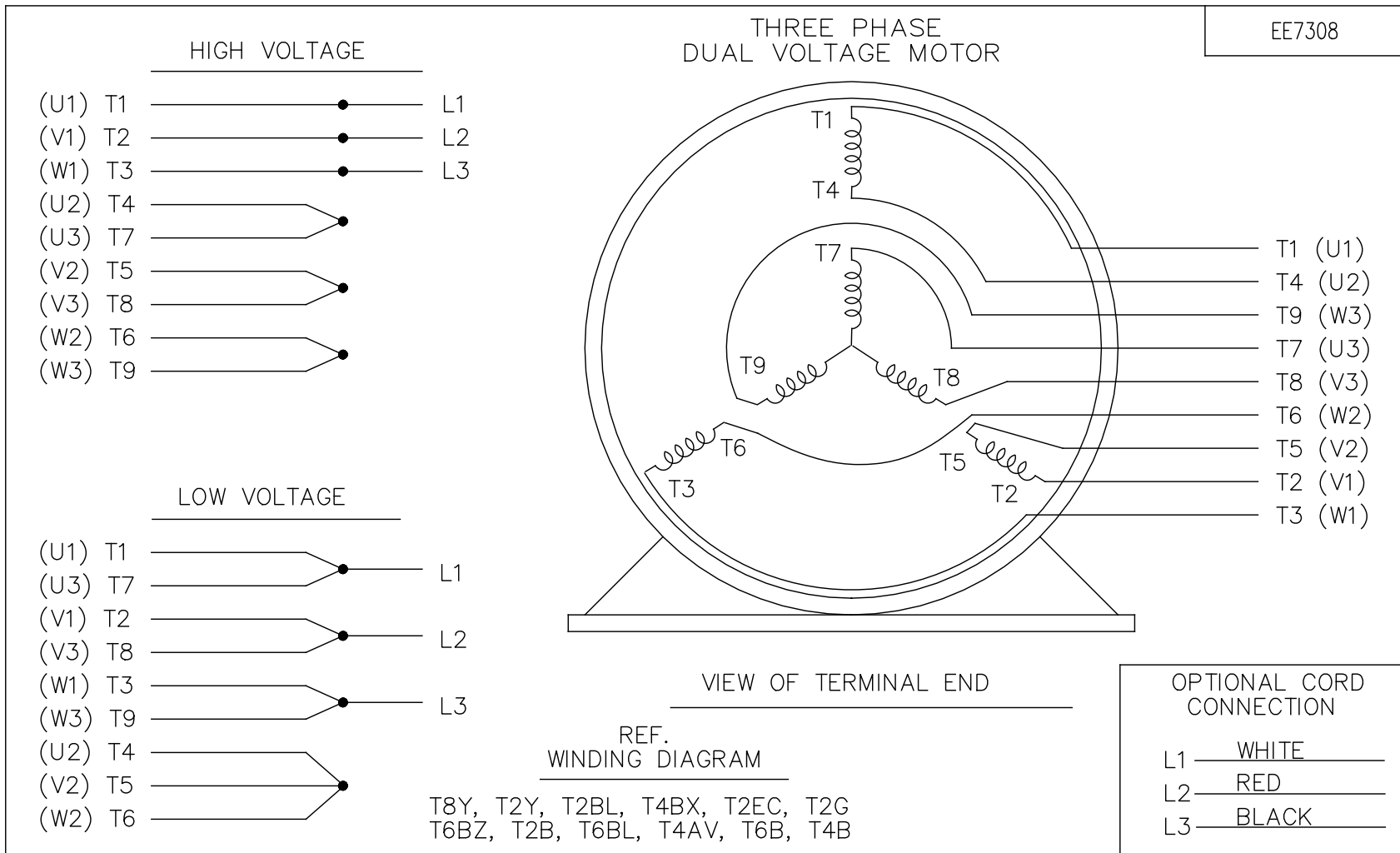

NO.	REVISION	BY & DATE	CHK	ANG	TOLERANCES UNLESS SPECIFIED	FINISH	DRAWN RM				
5	CHG TO REGAL LOGO	SL 09/10/2015	AB	DEC.	INCHES	<b>Regal Beloit America, Inc.</b>	11/20/1990				
4	REVISED IEC NOTATIONS	MSG 11/15/2011	CMN	.X	±.1		CHK ML 11/21/1990				
3	ADDED IEC NOTATIONS... (U1), (V1) ETC. MU95194	MSG 5/10/2010	MJS	.XX	±.02	TITLE CONNECTION DIAGRAM 3Ø - DUAL VOLTAGE MOTOR	APPD SAS 04/24/2003				
2	ADDED THE OPTIONAL CORD CONNECTION MU46318	RDH 04/24/2003	DRS	.XXX	±.005		SCALE 1=1				
1	REDRAWN	RM 11/20/1990		.XXXX	±.0005	MAT'L.	REF				
					±7'30"		FMF				
THIS DRAWING IN DESIGN AND DETAIL IS OUR PROPERTY AND MUST NOT BE USED EXCEPT IN CONNECTION WITH OUR WORK ALL RIGHTS OF DESIGN AND INVENTION ARE RESERVED THIS IS AN ELECTRONICALLY GENERATED DOCUMENT - DO NOT SCALE THIS PRINT						RFP	CAD FILE ee7308	SIZE A	DRAWING NO. EE7308	PAGE OF 5	REV. 5
						DIST WP					



FORM 3531 REV.3 02/07/99

\*\* Subject to change without notice.



Submital  
Data @ 460 V

Date: 8/24/2017  
 Customer:   
 Attention:   
 Submitted by: VINAYAK VERARTE

Motor Load Data

Load	0%	25%	50%	75%	100%	115%	125%	LR
Current (Amps)	0.50	0.56	0.60	0.70	0.80	0.82	0.85	5.0
Torque (ft-lb)	0.00	0.25	0.50	0.75	1.00	1.20	1.30	4.3
RPM	1800	1785	1770	1750	1725	1,720	1715	0
Efficiency (%)		51.5	66.5	67.5	68.0	70.0	72.5	
P.F. (%)	12.5	27.0	40.0	51.0	61.9	65.0	66.5	70.0

Motor Speed Data

	LR	Pull-Up	BD	Rated	Idle
Speed (RPM)	0	900	1565	1725	1800
Current (Amps)	5.0	4.5	3.6	0.80	0.50
Torque (ft-lb)	4.3	3.9	5.3	1.00	0.00

Information Block

HP	0.3
Sync. RPM	1800
Frame	56
Enclosure	TENV
Construction	TR
Voltage	208-230/460#190/380 V
Frequency	60 Hz
Design	B
LR Code letter	N
Service Factor	1.15
Temp Rise @ FL	50 °C
Duty	CONT
Ambient	40 °C
Elevation	1,000 feet
Rotor/Shaft wkt	0.04 Lb-Ft²
Ref Wdg	ZT412 TR
Sound Pressure @ 1M	62 dBA
VFD Rating	NONE
Outline Dwg	A-100142-606
Conn. Diag	A-EE7308
Additional Specifications:	
0	
EQUIV CKT (OHMS / PHASE)	
R1	R2
23.9940	18.2320
X1	X2
27.8640	18.5760
Xm	
489.3400	

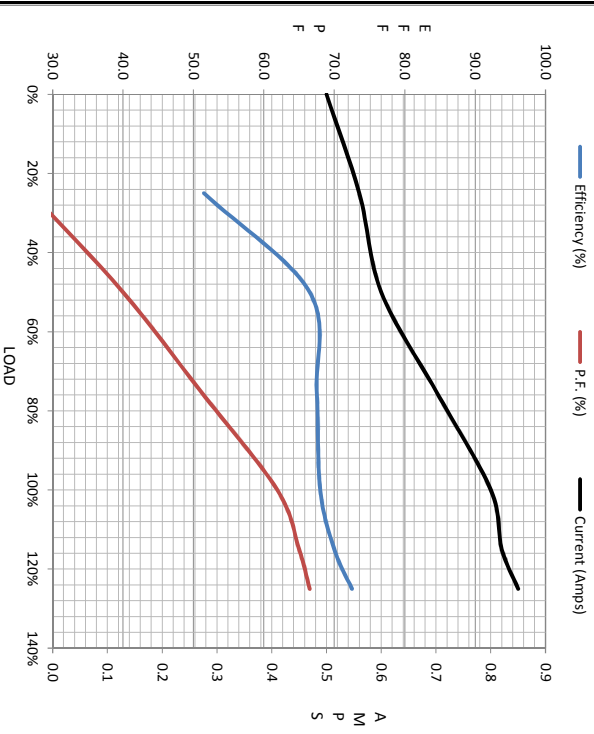

Speed -Torque Curve

