

PRODUCT INFORMATION PACKET

marathon[®]
Motors

Model No: 215TBFW7027
Catalog No: I217
10,1800,TEFC,215T,1/60/230
Totally Enclosed Fan Cooled (TEFC)



Regal and Marathon are trademarks of Regal Beloit Corporation or one of its affiliated companies.
©2018 Regal Beloit Corporation, All Rights Reserved. MC017097E

REGAL[®]

Nameplate Specifications

Output HP	10 Hp	Output KW	7.5 kW
Frequency	60 Hz	Voltage	230 V
Current	41.5 A	Speed	1759 rpm
Service Factor	1	Phase	1
Efficiency	85.5 %	Duty	Continuous
Insulation Class	F	Design Code	L
KVA Code	H	Frame	215T
Enclosure	Totally Enclosed Fan Cooled	Overload Protector	No
Ambient Temperature	40 °C	Drive End Bearing Size	6307
Opp Drive End Bearing Size	6206	UL	Recognized
CSA	Y	CE	Y
IP Code	43		

Technical Specifications

Electrical Type	Capacitor Start Capacitor Run	Starting Method	Across The Line
Poles	4	Rotation	Selective Counterclockwise
Mounting	Rigid Base	Motor Orientation	Horizontal
Drive End Bearing	Ball	Opp Drive End Bearing	Ball
Frame Material	Rolled Steel	Shaft Type	T
Overall Length	21.09 in	Frame Length	12.40 in
Shaft Diameter	1.375 in	Shaft Extension	3.47 in
Assembly/Box Mounting	F1 Only		
Outline Drawing	A-SS88687-1240	Connection Diagram	A-EE9048MF

This is an uncontrolled document once printed or downloaded and is subject to change without notice. Date Created: 10/08/2018

SS88687

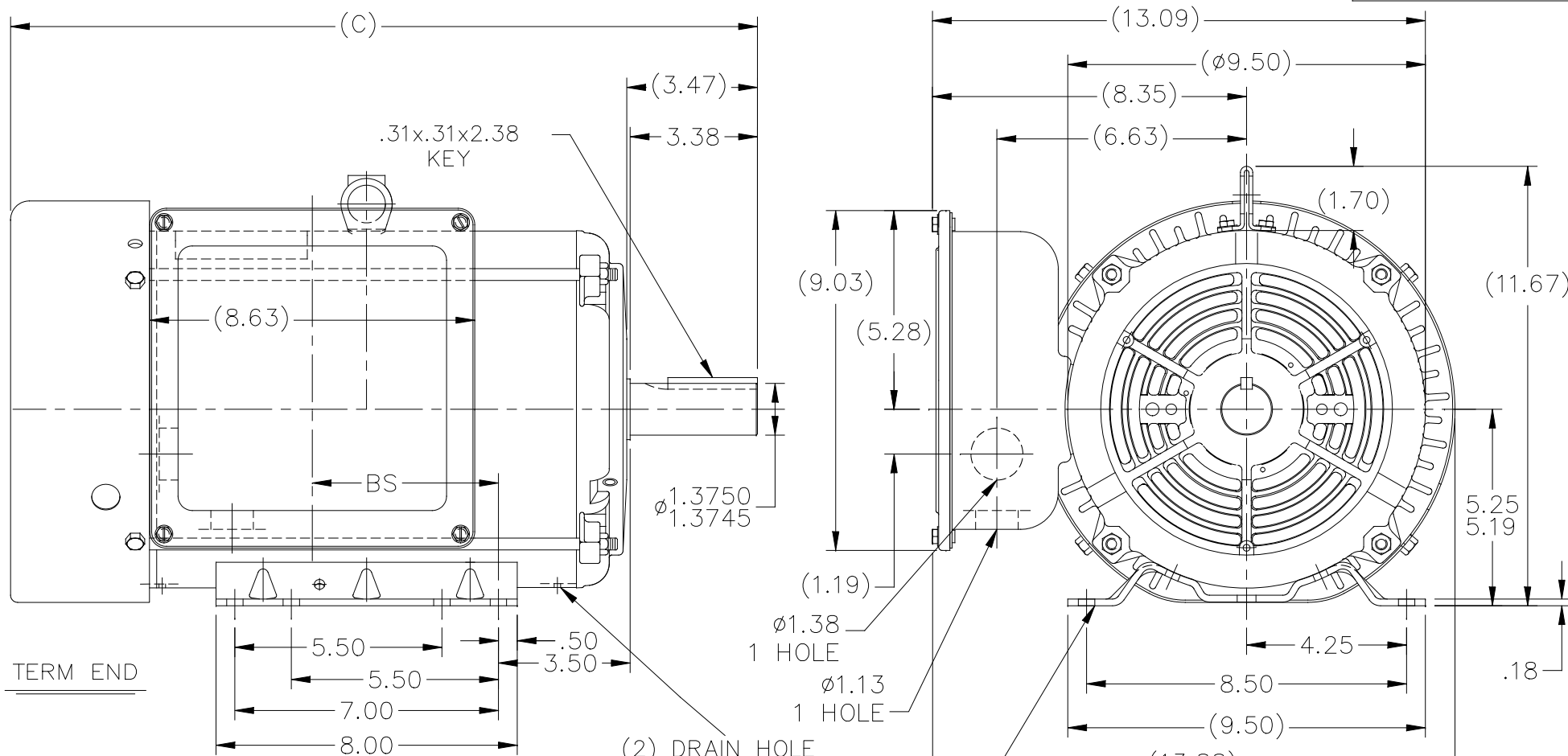

DASH	FR.	C	BS
965	213T	18.34	3.44
1115	213/15T	19.84	4.94
1240	215T	21.09	6.19

NOTES:
 1. NAMEPLATE TO BE READ FROM C'BOX SIDE OF MOTOR.
 2. DASH 965 TO BE READ FROM OPPOSITE SHAFT END

				TOLERANCES UNLESS SPECIFIED		REGAL™ Regal Beloit America, Inc.	DRAWN MJK 07-25-2007			
				DEC.	INCHES		CHK	MG	01-24-2008	
				.X	±.1	TITLE OUTLINE 210 FR. - TEFC - 1 PHASE	APPD	EH	01-24-2008	
				.XX	±.03		SCALE	1=4		
				.XXX	±.005		REF			
A	DRAIN HOLES ADDED		KIR 02/08/16	SS	.XXXX ±.0005	MAT'L.	FMF			
NO.	REVISION		BY & DATE	CHK	ANG ±7'30"	FINISH	PREV			
THIS DRAWING IN DESIGN AND DETAIL IS OUR PROPERTY AND MUST NOT BE USED EXCEPT IN CONNECTION WITH OUR WORK ALL RIGHTS OF DESIGN AND INVENTION ARE RESERVED THIS IS AN ELECTRONICALLY GENERATED DOCUMENT - DO NOT SCALE THIS PRINT				RFP	01-24-2008	CAD FILE ss88687	SIZE	DRAWING NO.	PAGE OF	REV.
				DIST	LB		A	SS88687		A

C.W. ROTATION

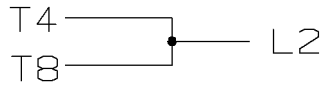
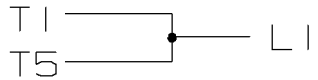

C.C.W. ROTATION

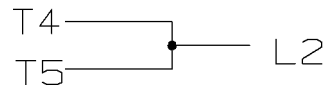
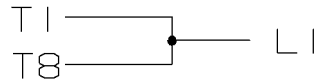

SINGLE VOLTAGE
CAPACITOR START
CAPACITOR RUN
REVERSIBLE

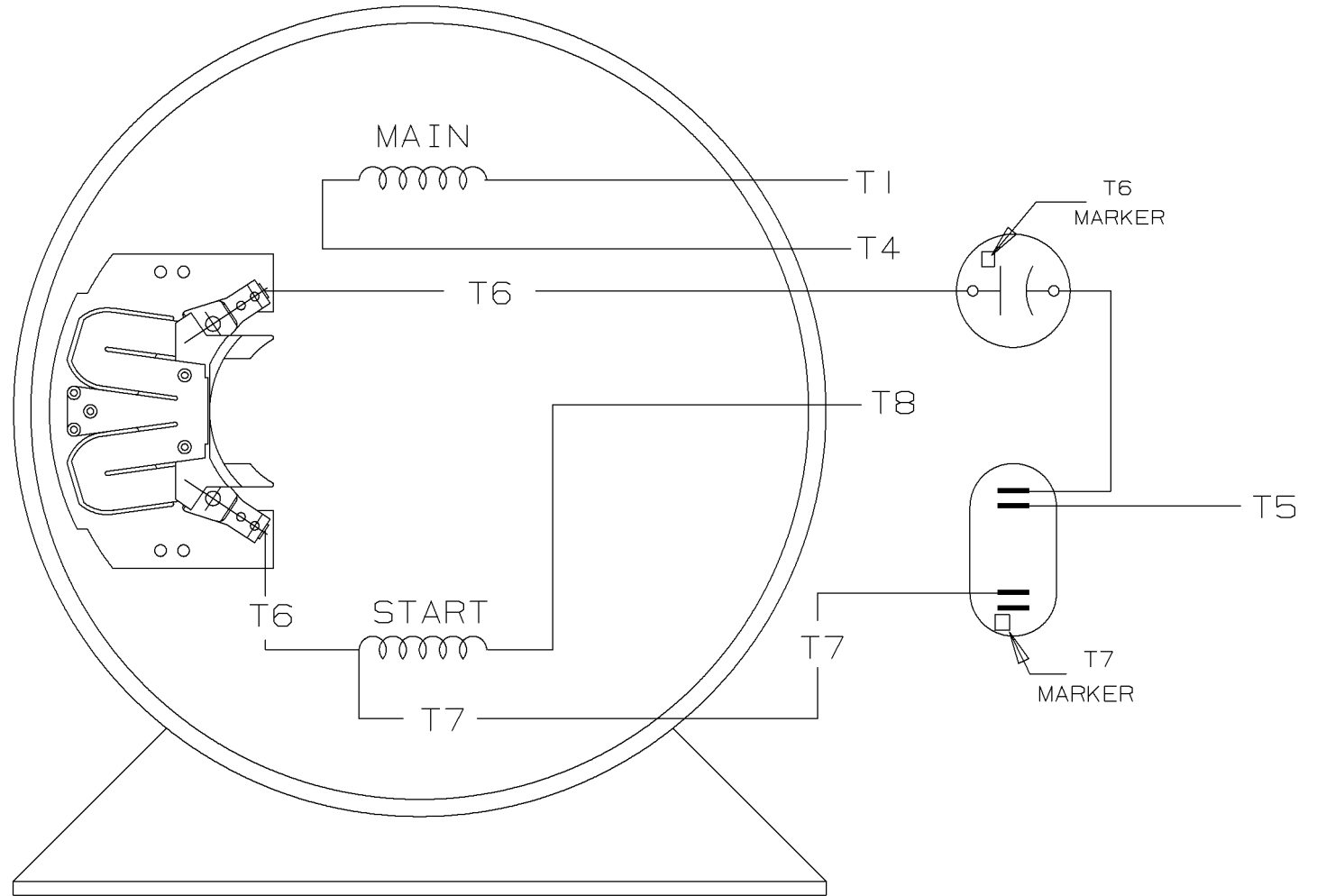

VIEW OF TERMINAL END

				✓ MAX. SURFACE ROUGHNESS UNLESS NOTED OTHERWISE	UNLESS OTHERWISE SPECIFIED DIMENSIONS ARE IN INCHES TOL. ON XX± XXX±.005 XXXX±.0005 ANGLES±		
				MATL SPEC	180 - 210 SWITCH	DRAWN BY	GK 11-01-1986
				FINISH	MARATHON ELECTRIC	CHKD BY	ML 11-01-1986
I	11-04-1986	NEW DRAWING	CN 7664C	GK	REFERENCE DRW.	WAUSAU, WISCONSIN 54401	APPD BY FG 11-04-1986
REV	DATE	CHANGE	NAME	PART NAME CONNECTION DIAGRAM			DRWG NO A-EE9048MF

SHOP BOOK

PURCHASED

DISTRIBUTION - WA - LB - WP - LM - BR

CADD FILE NO.

EE9048MF

MARATHON ELECTRIC CORPORATION

TYPICAL PERFORMANCE CURVE for AC MOTOR

Customer CATALOG

Curve at

230

Volts

HP 10.00

PHASE 1

Model No 215TBFW7027

60

HZ

VOLTS 230

10

HP

Catalog No I217

HZ 60

RPM 1759

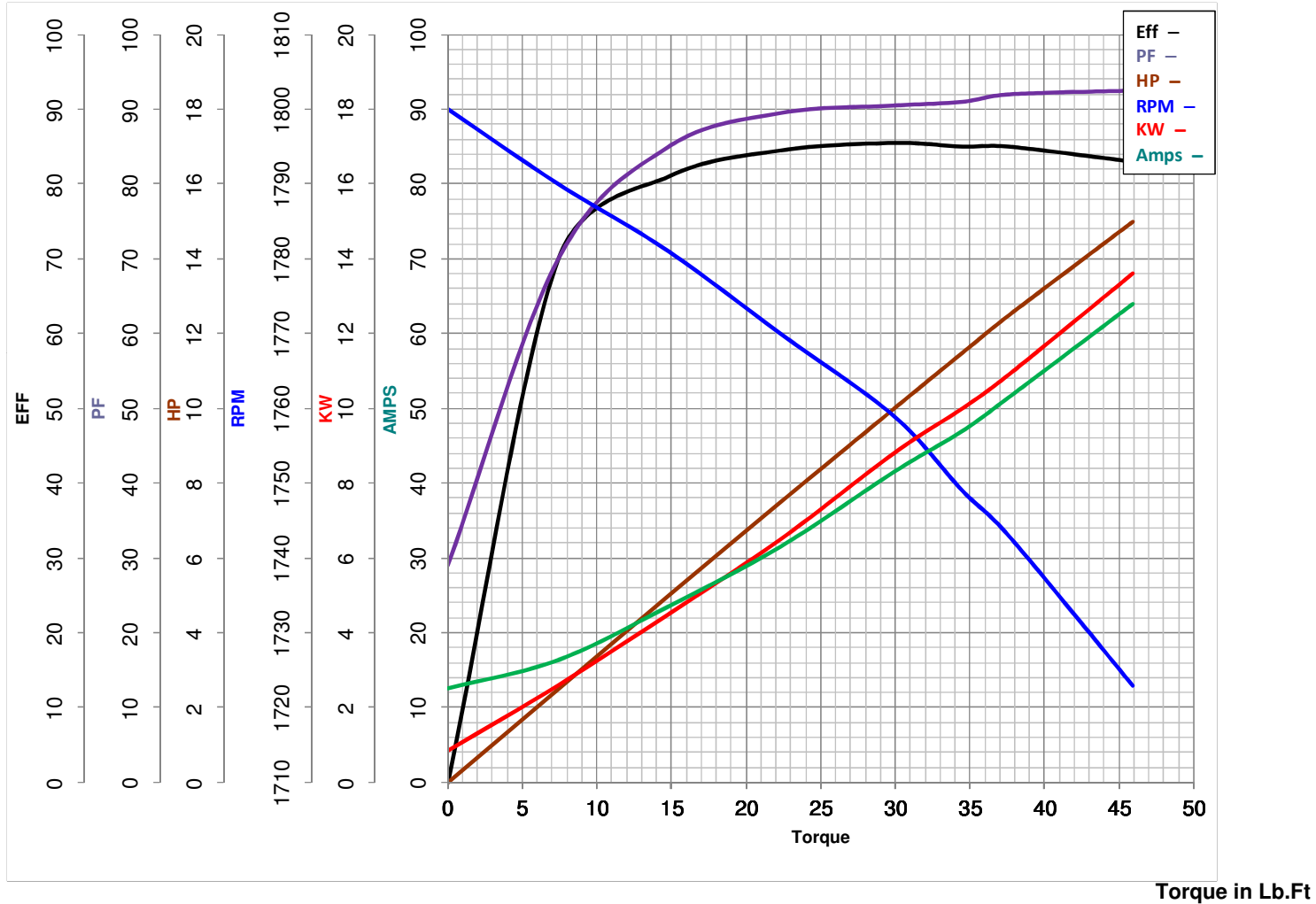

Torque in Lb.Ft

FL TORQUE 29.9 Lb.Ft
 BD TORQUE 79.7 Lb.Ft
 LR TORQUE 55.2 Lb.Ft

FL AMPS 41.5
 PU TORQUE 53.0 Lb.Ft
 LR AMPS 260

WINDING BK104125-2 Prepared By SRIKANTH

Date 6/20/2017