

e-SH REPAIR PARTS

316SS END SUCTION CENTRIFUGAL PUMP (60 HZ)

Effective August 1, 2019

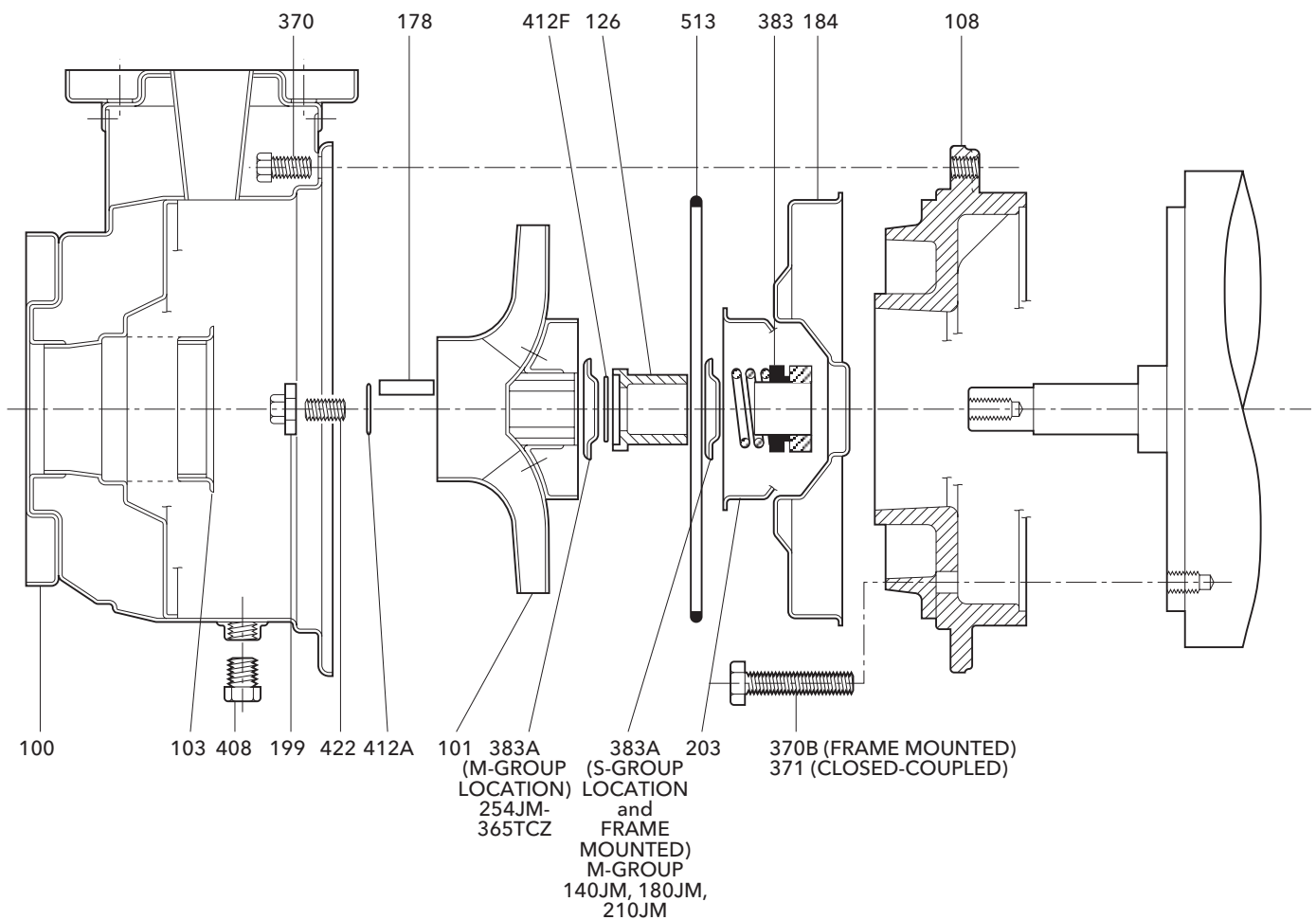

e-SH S-GROUP

Item No.	Part Description	Material	1x2-6		1½x2½-6		2x2½-6		2½x3-6		1x2-8		1½x2½-8		2x2½-8		1x2-10		Max. Wt. (lb)
			01SH06		15SH06		02SH06		25SH06		01SH08		15SH08		02SH08		01SH10		
100	Casing with wear ring		1L450		1L453		1L456		1L459		1L451		1L454		1L457		1L452		17
101	Impeller	AISI Type 316SS	6 ¹ / ₁₆	2L978	6¾	2L876	6 ⁹ / ₁₆	2L945	7 ⁵ / ₃₂	2L961	8 ³ / ₁₆	2L972	8¼	2L879	8¼	2L985	9 ⁴¹ / ₆₄	2L965	7
			5 ²⁹ / ₃₂	2L979	6 ³ / ₈	2L874	6 ³ / ₁₆	2L946	6 ²⁷ / ₃₂	2L962	7 ⁴³ / ₆₄	2L973	7 ¹³ / ₁₆	2L878	7¾	2L986	8 ¹³ / ₁₆	2L966	
			5 ³⁵ / ₆₄	2L980	6 ¹ / ₁₆	2L872	5 ¹³ / ₁₆	2L947	6½	2L983	7 ²¹ / ₆₄	2L974	7	2L877	7½	2L987	8 ²¹ / ₃₂	2L967	
			5 ²³ / ₆₄	2L981	5 ⁵ / ₈	2L871	5½	2L948	6 ¹⁹ / ₆₄	2L963	7	2L975	6¾	2L876	7 ³ / ₁₆	2L988	8 ³ / ₁₆	2L968	
			4 ⁶¹ / ₆₄	2L982	5 ⁵ / ₁₆	2L870	5 ¹ / ₈	2L949	5¾	2L984	6 ¹¹ / ₁₆	2L976	6 ⁷ / ₁₆	2L875	6 ⁷ / ₈	2L989	8	2L969	
					4 ¹¹ / ₁₆	2L869	4 ¹³ / ₁₆	2L950	5½	2L964	6¼	2L977	6 ¹ / ₈	2L873	6 ³ / ₁₆	2L990	7¾	2L970	
					4 ³ / ₈	2L868	4 ⁷ / ₁₆	2L951									7 ¹³ / ₆₄	2L971	
103	Wear ring, casing		4L465		4L466		4L467		4L468		4L465		4L466		4L467		4L465		1
184	Seal housing with ring		1L465			1L469		1L472		1L466			1L470		1L467				3
203	Wear ring, seal housing		See Item 100				4L464		See Item 100										
126	Shaft sleeve	316SS	4L453		4L456				4L473		4L456			4L473					
178	Key, impeller	Steel					4K11			4K555		4K11		4K555				1	
422	Stud, impeller		13K217																
199	Washer, impeller	316SS	4L458																
108	Motor adapter, 143-184JM and S-group brg. frame	CI ASTM A48 CL 20	1L554		1L50			1L99		1L560		1L52		1L99		1L562		25	
	Motor adapter, 213-256JM		1L555		1L51			1L98		1L561		1L53		1L98		1L563		29	
370	Bolt, casing	300SS	13L38				13L89		13L38			13L89				-			
371 or 370B	Bolt, adapter, 143-184JM and S-Group brg. frame	Steel SAE 1200	13K360		13L43				13K360		13L43			13K360		25			
	Bolt, adapter, 213-256JM		13K379		13L41			13K245		13K361		13L40		13K245		13K361		29	
383	Mech. seal - standard	Type 21	10K27 - Carbon/Silicon-Carbide/Viton																
	Mech. seal - high temp.		10K19 - Carbon/Silicon-Carbide/EPR																
	Mech. seal - severe duty		10K64 - Silicon-Carbide/Silicon-Carbide/Viton																
383A	Retainer, seal spring	316SS	4K517																
408	Plug, vent and drain		6L60																
412A	O-ring, impeller washer	Viton	5K320 standard (5K195 EPR option)																
412F	O-ring, shaft sleeve		5K307 standard (5K306 EPR option)																
513	O-ring, casing - standard		5K407				5L70		5K408			5L70		5L71			1		
	O-ring, casing - optional	EPR	5K393				5K317		5K394			5K317		5L110					

e-SH M-GROUP (254JM-365TCZ)

Item No.	Part Description	Material	1½x2½ -10		2x2½-10		2½x3-8		2½x3-10		3x4-8		3x4-10		Max. Wt. (lb)
			15SH10		02SH10		25SH08		25SH10		03SH08		03SH10		
100	Casing with wear ring		1L455		1L458		1L460		1L461		1L463		1L464		17
101	Impeller	AISI Type 316SS	9 ⁷ / ₈	2L778	9 ⁷ / ₈	2L790	9 ¹ / ₁₆	2L952	10 ³ / ₈	2L804	9 ¹ / ₁₆	2L825	10 ⁵ / ₈	2L836	8
			9½	2L779	9½	2L791	8¾	2L953	9 ¹⁵ / ₁₆	2L805	8 ¹¹ / ₁₆	2L826	10¼	2L837	
			9 ³ / ₁₆	2L780	9 ¹ / ₈	2L792	8½	2L954	9 ⁹ / ₁₆	2L806	8 ⁷ / ₁₆	2L827	9 ¹³ / ₁₆	2L838	
			8 ⁷ / ₈	2L781	8 ¹³ / ₁₆	2L793	8¼	2L955	9¼	2L807	8 ¹ / ₁₆	2L828	9 ⁷ / ₁₆	2L839	
			8 ⁹ / ₁₆	2L782	8 ³ / ₁₆	2L794	7 ⁷ / ₈	2L956	8¾	2L809	7 ¹¹ / ₁₆	2L829	9 ¹ / ₁₆	2L825	
			8¼	2L783	7 ¹⁵ / ₁₆	2L795	7½	2L957			7½	2L830	8 ¹¹ / ₁₆	2L826	
					7 ¹¹ / ₁₆	2L796	7 ¹ / ₈	2L958			7 ¹ / ₈	2L831			
							6 ¹¹ / ₁₆	2L959			6 ⁷ / ₈	2L832			
							6½	2L960			6½	2L833			
											6	2L834			
								5½	2L835						
103	Wear ring, casing		4L467			4L468			4L469			1			
184	Seal housing with ring		1L468			1L473	1L474	1L474	1L478	3					
203	Wear ring, seal housing		4L201			4L464									
126	Shaft sleeve	316SS	4L457												1
178	Key, impeller	Steel	4K261												
422	Stud, impeller		13K301												
199	Washer, impeller	316SS	4L463												
108	Motor adapter, 254-256JM and M-group bearing frame	CI ASTM A48 CL 20	1L91			1L89			1L93			1L94			31
	Motor adapter, 280JM-365TCZ		1L90			1L88			1L92			1L95			44
370	Bolt, casing	300SS	13L86 (6 req'd)			13L89 (8 req'd)			13L86 (8 req'd)			13K45 (8 req'd)			-
371 or 370B	Bolt, adapter, 254-256JM and S-Group bearing frame	Steel SAE 1200	13L88					13L116					-		
	Bolt, adapter, 280JM-365TCZ		13L87					13L115					-		
383	Mech. seal - standard	Type 21	10K45 - carbon/silicon-carbide/viton												1
	Mech. seal - high temp.		10K20 - Carbon/silicon-carbide/EPR												
	Mech. seal - severe duty		10K65 - Silicon-carbide/silicon-carbide/viton												
383A	Retainer, seal spring	316SS	4K500												2
408	Plug, vent and drain		6L60												
412A	O-ring, impeller washer	Viton	5K309 standard (5K308 EPR option)												1
412F	O-ring, shaft sleeve		5K309 standard (5K308 EPR option)												
513	O-ring, casing - standard		EPR	5L71			5L70			5L71			5L72		
	O-ring, casing - optional	5L110			5K317			5L110			5L116				

e-SH M-GROUP (140JM, 180JM&210JM)

Item No.	Part Description	Material	1½x2½-10		2x2½-10		2½x3-8		2½x3-10		3x4-8		Max. Wt. (lb)
			15SH10		02SH10		25SH08		25SH10		03SH08		
100	Casing with wear ring		1L455		1L458		1L460		1L461		1L463		17
101	Impeller	AISI Type 316SS	9 ⁷ / ₈	2L784	9 ⁷ / ₈	2L797	9 ¹ / ₁₆	2L991	9 ¹⁵ / ₁₆	2L817	9 ¹ / ₁₆	2L840	8
			9½	2L785	9½	2L798	8½	2L992	9 ⁹ / ₁₆	2L818	8 ⁷ / ₁₆	2L841	
			9 ³ / ₁₆	2L786	9 ¹ / ₈	2L799	8¼	2L993	9¼	2L819	8 ¹ / ₁₆	2L842	
			8 ⁷ / ₈	2L787	8 ¹³ / ₁₆	2L800	7 ⁷ / ₈	2L994	8¾	2L821	7 ¹¹ / ₁₆	2L843	
			8 ⁹ / ₁₆	2L788	8 ³ / ₁₆	2L801	7 ¹ / ₈	2L995			7 ¹ / ₈	2L844	
			8¼	2L789	7 ¹⁵ / ₁₆	2L802	6 ¹¹ / ₁₆	2L996			6½	2L845	
					7 ¹¹ / ₁₆	2L803					6	2L846	
											5½	2L847	
103	Wear ring, casing		4L467			4L468			4L469			1	
184	Seal housing with ring		1L468			1L473		1L475		1L475		3	
203	Wear ring, seal housing		4L201			4L464							
126	Shaft sleeve	316SS	4L457										
178	Key, impeller	Steel	4K261										1
422	Stud, impeller		13K301										
199	Washer, impeller	316SS	4L463										
108	Motor adapter, 143-184JM and S-group bearing frame	CI ASTM A48 CL 20	1L91			1L89		1L93				25	
	Motor adapter, 213-256JM		1L90			1L88		1L92				29	
370	Bolt, casing	300SS	13L86 (6 req'd)			13L89 (8 req'd)		13L86 (8 req'd)				-	
371 or 370B	Bolt, adapter, 143-184JM and S-Group bearing frame	Steel SAE 1200	13L88					13L116				-	
	Bolt, adapter, 213-256JM		13L87					13L115				-	
383	Mech. seal - standard	Type 21	10K45 - carbon/silicon-carbide/viton										1
	Mech. seal - high temp.		10K20 - Carbon/silicon-carbide/EPR										
	Mech. seal - severe duty		10K65 - Silicon-carbide/silicon-carbide/viton										
383A	Retainer, seal spring	316SS	4K500										
408	Plug, vent and drain		6L60										2
412A	O-ring, impeller washer	Viton	5K309 standard (5K308 EPR option)										1
412F	O-ring, shaft sleeve		5K309 standard (5K308 EPR option)										
513	O-ring, casing - standard	EPR	5L71			5L70		5L71					
	O-ring, casing - optional		5L110			5K317		5L110					

Xylem Inc.

2881 East Bayard Street Ext., Suite A, Seneca Falls, NY 13148

Phone: (866) 673-0445 Fax: (888) 322-5877

www.xylem.com/goulds

