

MYERS[®] MSC150 Series

Heavy Duty Cast Iron Submersible Sump Pumps

SPECIFICATIONS

Applications	Basement sumps dewatering	
Capacities	87 GPM	329 LPM
Shut-off head	29'	8.84 m
Operation:		
Tethered: On	13-1/2"	343 mm
Off	4-1/2"	114 mm
Vertical: On	7-1/2"	190.5 mm
Off	3"	76 mm
Diaphragm: On	9"	228.6 mm
Off	4-1/2'	114 mm
Solids handling	3/8"	9.6 mm
Intermittent liquid temp	32°F to 70°F	0°C-21°C
Motor	PSC Motor	
Electrical data	115V, 60 HZ., 15 Amp Circuit	
Individual Branch Circuit		
Required (min.)	15 Amps.	
Acceptable pH range	6-9	
Shaft seal type	2x Double lip	
Motor housing	Cast iron	
Volute case	Cast iron	
Impeller	Recessed vortex impeller	
Power cord	10' 18/3 SJTW optional cord lengths are available	3.05 m
Discharge, NPT	1-1/2"	
Min. sump diameter	10"	254 mm
Agency Approval	CSA, CUS	

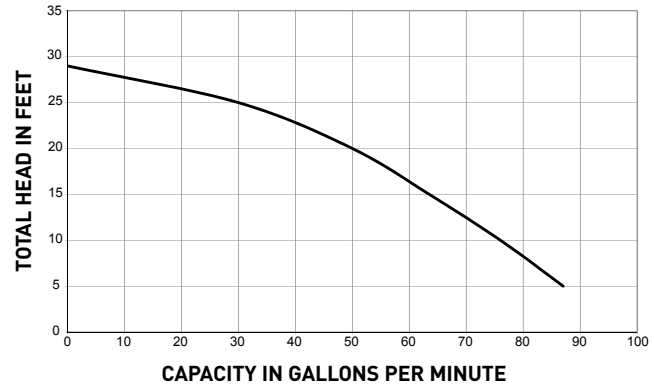

3 YEAR
WARRANTY

FEATURES

- Performance where it counts with 76 GPM at 10'
- Heavy-duty cast iron construction
- Upper and lower double lip seals deliver smoother operation
- Dual ball bearings
- Permanent split capacitor (PSC) motor promotes less energy consumption and longer life
- Multiple automatic switch options
- Raised inlet to reduce the maintenance time

MODEL NUMBERS

MSC150V10	MSC150T10	MSC150D10
MSC150V20	MSC150T20	MSC150D20
MSC150V50	MSC150T50	MSC150M20

MYERS[®] MSC150 Series

Heavy Duty Cast Iron Submersible Sump Pumps

DIMENSIONS

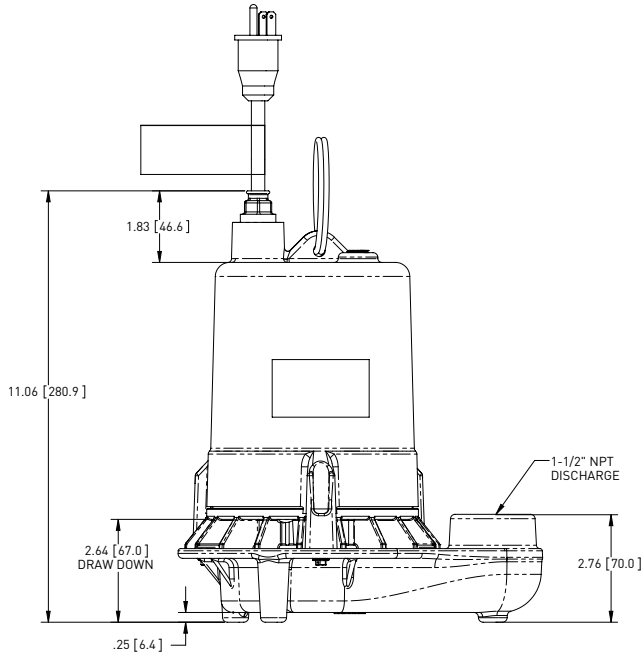

7036 0216

TETHERED AUTOMATIC

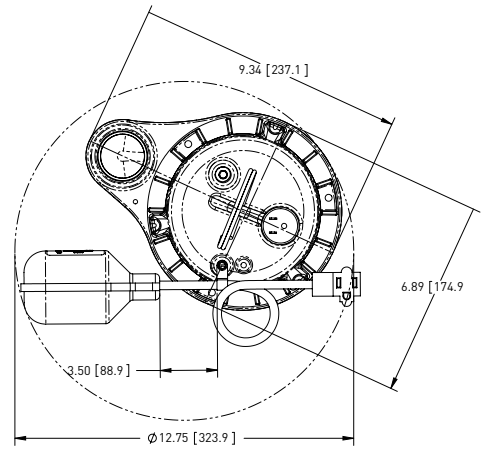

VERTICAL AUTOMATIC

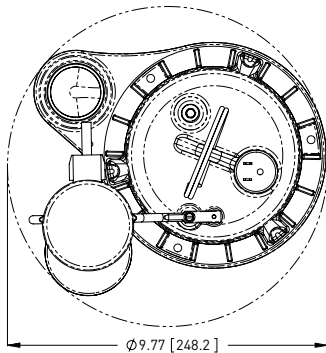

DIAPHRAGM AUTOMATIC

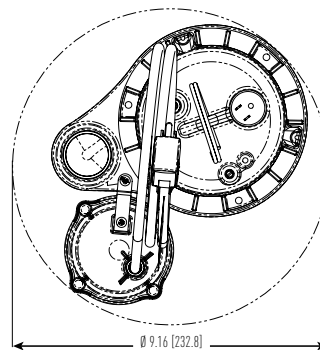

USA
293 WRIGHT STREET, DELAVAN, WI 53115 WWW.FEMYERS.COM
PH: 888-987-8677 ORDERS FAX: 800-426-9446

CANADA
490 PINEBUSH ROAD, UNIT 4, CAMBRIDGE, ONTARIO, N1T 0A5
PH: 800-363-7867 FAX # 888-606-5484

Because we are continuously improving our products and services, Pentair reserves the right to change specifications without prior notice.