

**⚠ WARNING Risk of electric shock.** Can shock, burn or kill. Risk of issues to be aware of:

- Drive's internal components retain high voltage for up to 5 minutes after input power is disconnected

**NOTICE:** See Owner's Manual for more illustrations and detailed information.

Tank air pressure must be at 70% of the system's set-point.

### Pump Start-Up

The discharge pressure of the pump equals the pressure produced by the pump plus the pressure on the suction side of the pump.

Make sure that the suction and discharge shutoff valves are both open.

When the system is connected to the power supply it initializes. The green LED will be ON and the Pentair logo shows up on the display (Figure a). As this initialization ends, the pump stops and the display shows STOP (Figure b).

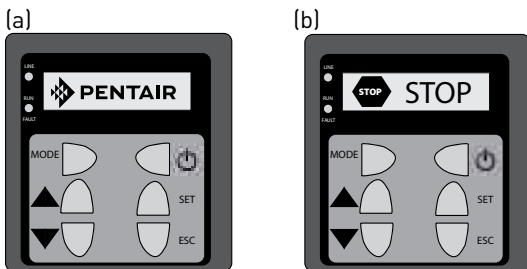

If you need to change the set-point, wait for the initialization to complete and then push the up ▲ or down ▼ button. Hold down the button until the desired set-point is displayed.

1. Start the pump by pressing on the ON/OFF ⏻ button.

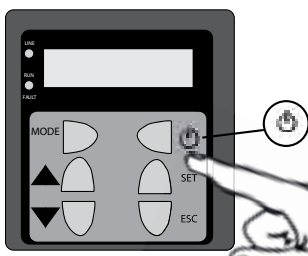

The pump starts and reaches the pressure level set at the factory (default is 60PSI). The RUN/FAULT LED will be ON and showing green. If the system pressure is equal to or higher than the factory pressure setting, the pump will be in stand-by mode (green LED ON), ready to start if the pressure decreases.

2. The pump should start when the pressure drops below the set-point and pressure should return to the set-point and stay there. Do not run the pump with the discharge shut-off valve closed! If the system goes to PROTECTION mode, refer to the "Quick Troubleshooting Guide".

### Programming

#### 1. Language setting:

To change the language, press the SET button

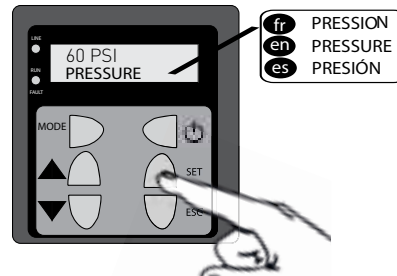

#### 2. Display setting:

Press MODE to change the display configuration and choose between GRAPHIC (a) and TEXT (b) modes.

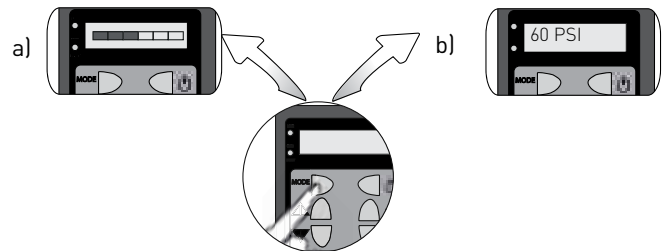

#### 3. Pressure level setting (set-point):

To increase or decrease the set-point, press the up ▲ or down ▼ buttons

